

Personal Device Settings to **TURN OFF** for RTNJ-Events access

These default settings on your personal devices are designed to protect your device on open & unsecured networks, such as public wifi and home networks. Randolph's network is designed with enterprise level security and web filtering to ensure students and staff devices are as safe and secure as possible. The below settings can interfere with our systems, and should be turned off to allow your device to access the resources needed. Turning off these settings that apply to RTNJ-Events will NOT interfere with your security on other networks.

*It is **HIGHLY** recommended that you schedule an on-site run through on a date before the actual event, to confirm access to any internet resource needed. Results from this can be used to adjust any security settings needed for the actual event.*

****Connect to RTNJ-Events first****

Screenshots show the setting in the ON State, Please turn the setting **OFF**.

Setting On: 

Setting Off: 

iOS - Settings | WiFi | Select RTNJ-Events

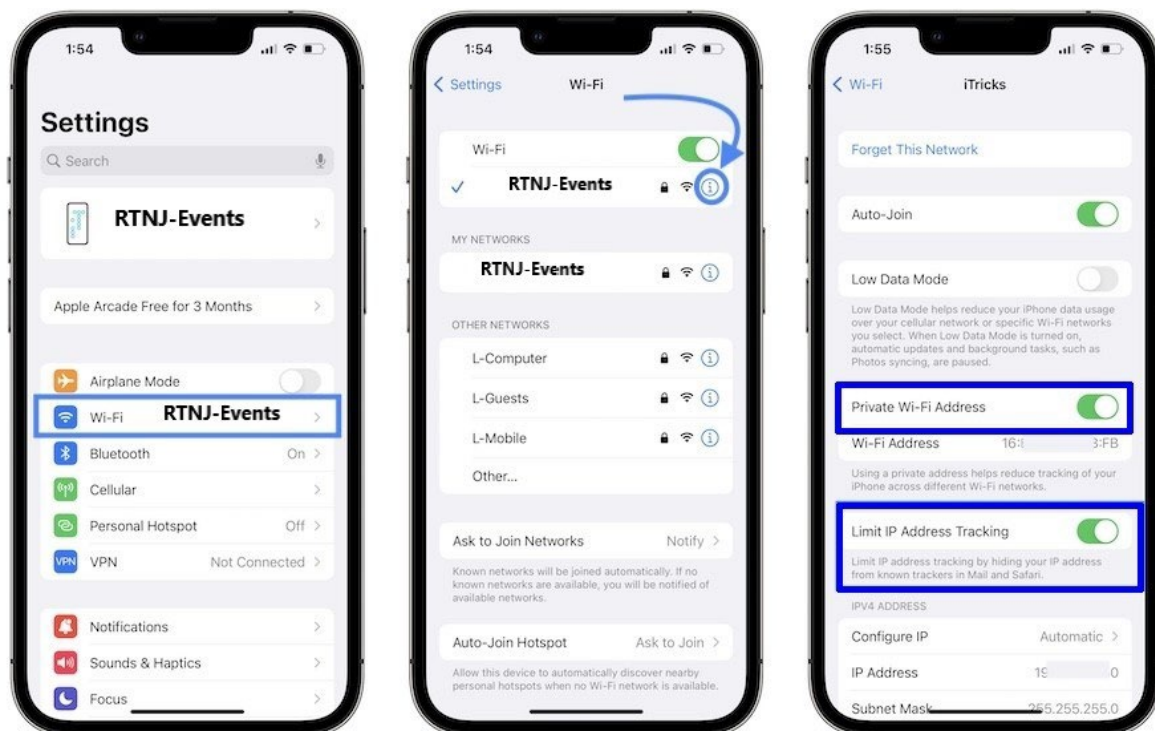

Settings | iCloud | Private Relay

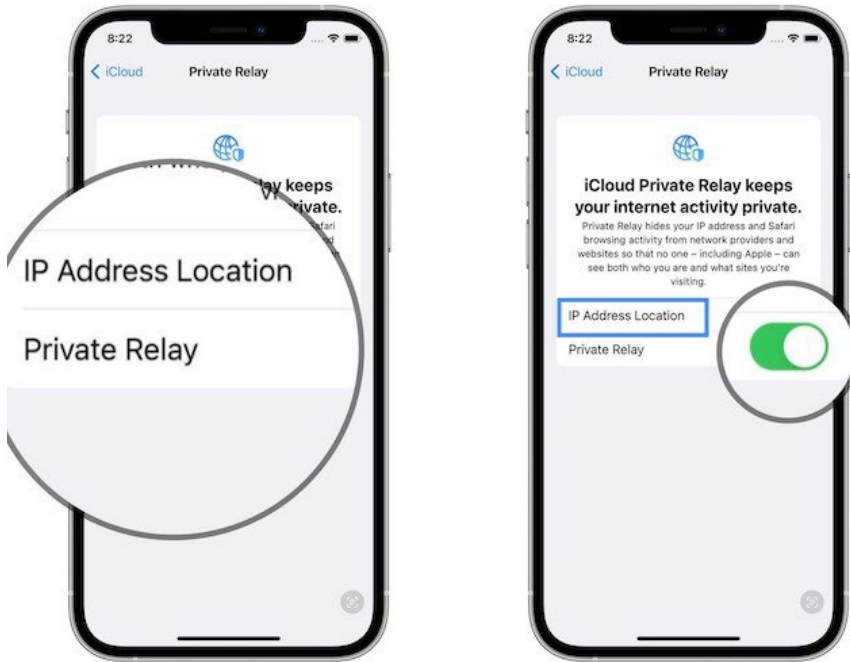

Settings | Phone | Wi-Fi Calling



Android:

Settings - Scroll down to bottom - Select More connection settings - Turn off Private DNS

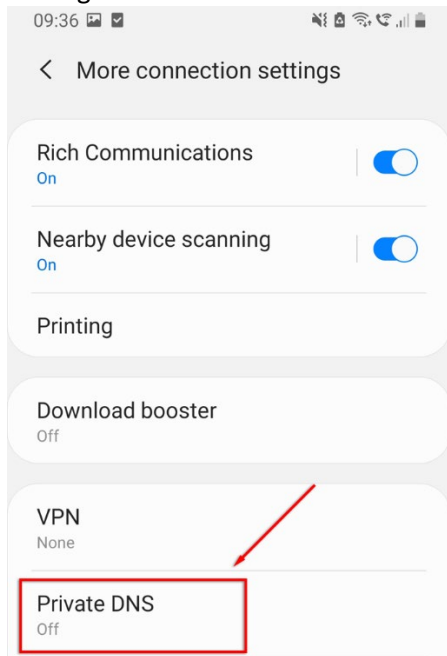

On SSID - turn off random mac address

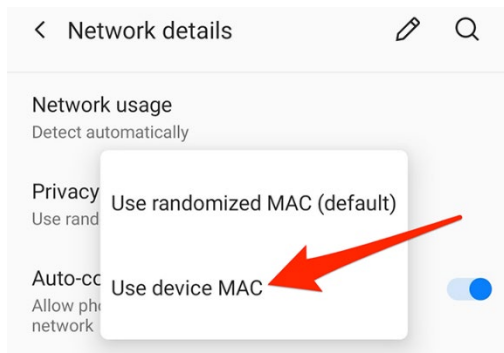

MacOS:

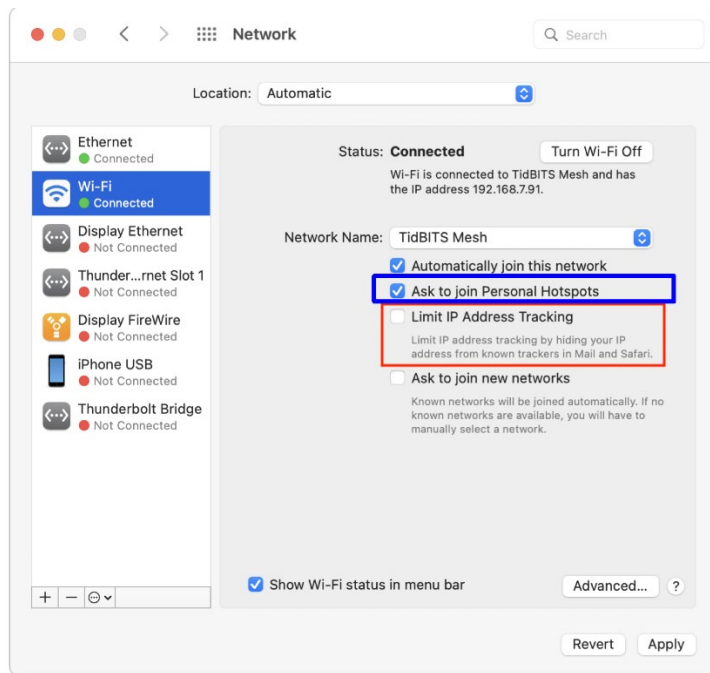

After these settings are configured on your corresponding personal device, Please open a browser and navigate to the preferred web resource of the event.